



225 Woodcrest Drive, Ephrata, PA 17522

Phone: 717.738.2233 Fax: 717.738.3128

www.WoodcrestRetreat.org info@WoodcrestRetreat.org

**To: Parents/Guardians of campers registered for
Pioneer I – June 24-28, 2024**

Thank you for registering your child for Woodcrest's overnight camp! We look forward to providing a fun, faith-filled and enriching experience for your camper.

MONDAY MORNING CHECK-IN:

9:00—9:30 AM (No earlier please) at Poplar View Pavilion.

The Overnight Camp sign will direct you after entering the property. Please drive slowly.

Due to improvement projects there is limited parking space this summer. **Please drop off luggage at designated spot in front of Poplar View Pavilion, then proceed to your parking spot.** There will be parking attendants to direct you.

PLEASE BRING TO MONDAY MORNING CHECK-IN:

1. Final payment (cash, check, or credit)
2. Authorization for Medication Administration Form *(if needed)*
(Any medications must be in original, labeled container)
3. Money for the Snack Bar (optional) will be collected at check-in (please do not pack in suitcase)

CAMP ACTIVITIES will include cooking meals over a fire, Bible lessons, sports, crafts, singing, nature activities, hiking, games, pool and waterslide. Campers will also enjoy night games, Forest Follies skit night, and this year's theme event evening.

PARENTS PROGRAM: Friday at 6:00 PM promptly and will include a recap of the week. This program will be held at the Poplar View pavilion and will last approx. 25 minutes. Campers will be dismissed following this program.

If you have any other questions, please call (717) 738-2233. Thank you and may God bless your summer. See you soon!

***NEW SUMMER 2024* All early pickups, late drop-offs, and other office related matters will be addressed in the Summer Camp Office in lower IRC, rather than the Main Office.**

Adam Fox
Program Director

Joel Wenger
Overnight Director

Joel Wayde
Asst. Program Director

Things to Bring

Camper's gear list:

- Bible (if you have one)
- sleeping bag, pillow
- swimsuit (one piece)
- towel
- rain coat
- jacket / sweatshirt
- soap / shampoo
- toothbrush, toothpaste
- insect repellent
- sunscreen
- water bottle (name labeled)
- flashlight
- close-toed shoes
- extra shoes for rainy days
- bag or backpack
- comfortable clothing for each day, name labeled
- old clothes for mess fest
- **OPTIONAL:** \$ for snack bar, will be collected at check-in

DRESS GUIDELINES:

We encourage campers to choose modest clothing. Campers may be asked to change if their clothing does not adhere to the dress guidelines as listed on the enclosed Summer Camp Information Sheet.

Please do not bring:

- ✓ radios, iPods, MP3s, etc.
- ✓ electronic toys
- ✓ cell phones, tablets
- ✓ pocket knives
- ✓ food or candy

OVERNIGHT CAMP FAQs

When is pick up and drop off?

ARRIVAL/DEPARTURES Check-in and camper drop-off happens between 9:00 to 9:30am on the first day of camp at Poplar View Pavilion. Please be prompt. Each camp week ends with a Parent Program at 6:00pm followed by Camper Pick-Up held at Poplar View Pavilion.

If you will need arrangements for picking up your camper outside of the typical camp schedule please see the Overnight Camp Director at Check-in to fill out a Special Arrival and Departure Form.

Can I pay my balance when I arrive?

PAYMENT OF CAMP The remaining payment must be paid on Wednesday morning at the registration table. All payments check or cash preferred.

What is Woodcrest's refund policy?

REFUND POLICY All deposits are non-refundable & non-transferable. No refunds will be given except for medical emergencies. Children that are sent home for inappropriate behavior or homesickness are not eligible for a refund.

What do I need to bring at Friday pick-up?

Campers will only be released to persons listed as authorized to pick up. If you need to update this information you can do so on Campwise under the camper profile form. Please make sure to bring photo identification when picking up your camper because it is required that we verify your identity, regardless of your relationship to the camper. This applies to anyone picking up a camper from camp.

If I forgot an item for my camper, can I come drop it off?

CAMP VISITATION - In order to provide a safe environment for all campers visitors are discouraged and must be approved by the administration before visiting. All guests must register at the office before proceeding into camp. **If you need to drop off an item for your camper please label it with your camper's name and leave it with the office.** Camp leadership will pick it up there and give it to your camper.

What safety measures does Woodcrest pursue?

FIRST AID AND SAFETY - Our summer staff team includes a Health Care Provider who is trained in first aid administration. In addition, a camp administrator lives on-site during the camp program. We ambitiously recruit counselors and staff members that possess quality Christian character, obtaining all necessary background checks and clearances. We also ensure all paid staff are CPR certified.

POOL - All campers must take a swimming test before entering the pool. The pool is supervised by both counselors and certified lifeguards.

What should I do if my camper has special dietary needs?

We are limited in our ability to accommodate special diets. If your camper needs a special diet while at camp please bring prepared food, labeled by meal, for them to Check-in. We will make sure it is stored properly and is given to them at the appropriate time. Any allergies should be noted on the camper medical form.

How does Woodcrest assign lodging?

Woodcrest assigns lodging by biologically born sex in according with the faith statement found on our website.

Should I bring spending money?

CAMP MERCH - Each camper will have the opportunity to buy camp merchandise at drop-off and pick-up. Camper spending money will be collected at check-in, please use bills in increments of \$10, \$5, and \$1 if possible.

SNACK BAR - Open in the evening after fireside and during pool hours. Items available at the snack bar include: soft pretzels, hot pockets, popcorn, slushies, root beer floats, ice cream, etc. Items range from \$0.50 - \$4.00.

Is there a dress code?

DRESS GUIDELINES- All clothing should be modest and suitable for outdoor activities. Please avoid clothing with images or wording contrary to Christian principles.

SHORTS: Mid-thigh or longer and not form fitting (please no writing on backside).

SHIRTS: Please avoid form fitting or low cut shirts. Midriff must be covered. Any tank tops need wide shoulder straps.

SHOES: Close-toed footwear or sturdy sandals only. Please bring an extra pair.

FLIP-FLOPS: These can only be worn when going to and from the pool or showers.

JEWELRY: Jewelry is generally discouraged in the active, outdoor setting of camp. Loose or dangling jewelry such as hoop earrings that pose a safety hazard are not allowed.

SWIMSUIT POLICY

Girls - Modest one-piece swimsuit, or a tankini-only if the fabric overlaps and does not show midriff (no bikinis). Boys - Swimsuits should be mid-thigh or longer.

How can I communicate with my camper?

Postal Mail Campers enjoy getting letters from loved ones while at camp. Postal mail that arrives for campers is distributed every evening after dinner. Please note that it often takes 2-3 days for postal letters to arrive at camp from most local areas. (Letters for Explorer week campers should be left with the registrar at Check-in due to the shortened camp week.) Campers are encouraged to write letters to friends and family. Outgoing camper mail is collected and mailed each day.

E-Mail You are able to send your camper *one-way* emails from the dashboard of your Campwise account. There is no charge for this service. The "Camper Account Login" button can be found on the Woodcrest Retreat website, on the Overnight Camp page, on the right hand side under Resources. Any emails sent through this system by 3:00pm will be distributed that evening at mail call. If you submit an email after 3:00pm it will be given to them at mail call the next evening. While campers are not able to reply to or send emails they are encouraged to write letters to friends and family.

What if my camper has a BHT?

BHT personnel or other types of behavioral supports are not permitted at overnight camp.

In what scenario would Woodcrest send my camper home early?

BEHAVIOR EXPECTATIONS - In the event that a camper's behavior is a hindrance to the rights or the safety of others, or the program, Woodcrest Retreat reserves the right to dismiss the camper upon consultation with the parent.

What items are not allowed at camp?

ELECTRONICS AND OTHER ITEMS TO LEAVE AT HOME - Summer camp provides children with a great opportunity to 'unplug' from their daily routine in a fun and exciting way. Woodcrest is also a place where we strive to put relationships with one another and God first. Electronic devices often hinder these goals and increase the likelihood of behavior problems. So, please make sure your camper leaves all electronics such as cell phones, ipods, cd/mp3 players, apple watches and similar devices at home because they are not permitted at camp.

Pocket knives are also not permitted at camp. Staff reserves the right to confiscate any item that compromise the safety, goals and values of camp for the duration of the program until dismissal.

CAMPER MEDICATION PRESCRIBER/PARENT AUTHORIZATION

If a camper must receive medication during his/her time at camp, please bring this completed form, along with the medication to camp registration. Present this completed form and medication to the Health Care Staff member at registration. Medication must be in the original, unopened, sealed container and be properly labeled with the campers name, prescriber's name, date of prescription, name of medication, dosage, strength, time interval, route of administration and the date of drug expiration when appropriate.

CAMPER INFORMATION

Campers Name _____ Todays Date: _____

MEDICATION #1

Name of Medication _____ Reason for Taking _____

Time of Day: _____:_____ am / pm	Dosage: _____	Notes: _____
_____ : _____ am /pm	Dosage: _____	Notes: _____
_____ : _____ am /pm	Dosage: _____	Notes: _____

Does medication require refrigeration? Yes No

MEDICATION #2

Name of Medication _____ Reason for Taking _____

Time of Day: _____:_____ am / pm	Dosage: _____	Notes: _____
_____ : _____ am /pm	Dosage: _____	Notes: _____
_____ : _____ am /pm	Dosage: _____	Notes: _____

Does medication require refrigeration? Yes No

MEDICATION #3

Name of Medication _____ Reason for Taking _____

Time of Day: _____:_____ am / pm	Dosage: _____	Notes: _____
_____ : _____ am /pm	Dosage: _____	Notes: _____
_____ : _____ am /pm	Dosage: _____	Notes: _____

Does medication require refrigeration? Yes No

PARENT AUTHORIZATION

I authorize the Summer Camp Health Director of Woodcrest Retreat the task of assisting my child in taking the above medication(s).

Signature of Parent _____	Date _____	Phone _____	Cell _____
---------------------------	------------	-------------	------------

Overnight Camp Memories

Camp T-Shirt

- New design!
- Available for purchase at Check-in.
- \$10

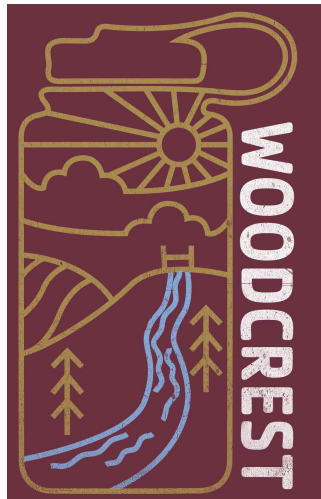

USB

- 8-10 minutes of camp fun
- Lots of photos from the week included
- Unique to each camp week
- Distributed at Closing Program
- \$12

Camp Group Photo

- Photo stock
- Distributed at Closing Program
- \$7
- Only available for purchase on Monday Morning



Camp is Growing!

You may notice that Woodcrest looks a little different this year, as construction improvements have disturbed portions of our grounds. We apologize for the less-than-perfect look around camp. At the same time, big things are happening at Woodcrest! As we have grown rapidly the past few years, Woodcrest has a vision to develop more ways to serve our community. This project, called Mission 4:12, will see new cabins and a program center built. The first phase, a new shower house, is complete and is in use this summer! We are excited to see how God will lead as we move forward, and hope you and your family will enjoy these improvements for years to come.

Learn more about our Mission 4:12 Initiative



Read stories from parents' and campers' experiences



Discover ways for businesses to partner with Woodcrest.



Make an online donation



THE PLAN

It is never a question of IF God's work is feasible – it is a matter of HOW to accomplish God's work and WHEN to start it. To this end, The Woodcrest Retreat Board conducted a feasibility study in summer 2022 to discuss with Woodcrest's stakeholders a proposed Master Plan. The results were exciting and have encouraged us to move forward with a multi-phased improvement campaign designed to help us grow for greater Kingdom impact.

PHASE I
\$350,000
NEW YEAR-ROUND
BATH HOUSE

PHASE II
\$1.8 MILLION
10 NEW YEAR-ROUND
CABINS - \$150,000/EACH

PHASE III
\$2 MILLION
MULTI-PURPOSE
PROGRAM CENTER

PHASE IV
YEAR-ROUND PROGRAMMING -
MAKING A GREATER IMPACT
FOR OUR YOUTH AND OUR
COMMUNITY AND GROWING
THE KINGDOM!

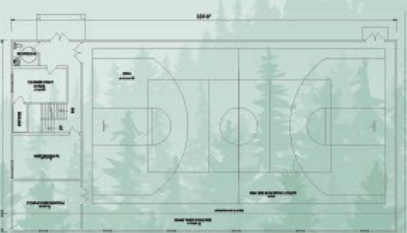
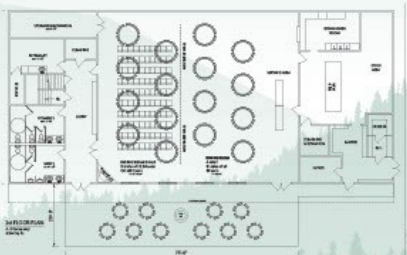
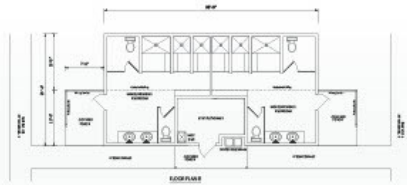

Future Camp Cabin



Future Program Center